

Curtain Motor

ORIGINALITY QUALITY
curtain motor makes you easy life



Smooth Running



Radio Control



Manual Operation



Large Load Assembled Fast



High Technology



FEATURES

Intelligent curtain motor for every common home

Manual Operation: When powered on, the curtain could be pull by hand with 10cm. Then the curtain open or close automatically

Manual operation without power: Without power, the curtain could be controlled by hand

Obstacle stop function: the motor could stop when it meets obstacle ,in order to protect the system

Automatical position: motor could remember the close and open position, users do not need to reset.

Multi-control: users can choose different ways to control, such as emitter or switch.

Freely assembling: DIY design and customized tracks.

MOTOR PARAMETER

Rated Torque	Nominal Voltage	IP	Nominal Consumption
1.2 Nm	AC100v~240v 50Hz/60HZ	IP20	40W
2 Nm	AC100v~240v 50Hz/60H	IP20	80W

EXPLODED VIEW

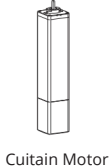
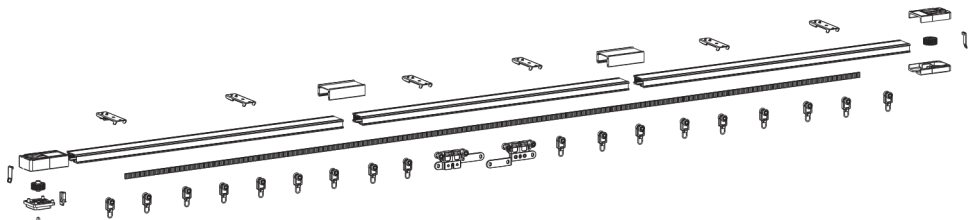

The solutions of intelligent curtain model

	Total length	Length of track (mm)	Track connector (mm)	Length of adjustable track(mm)					Suitable size
				Length of track(mm)			Track connector(mm)		
				1000	100	500	200	100	
1	2.2	1	1	1	2	1	1	1	< 2.16m
2	m	2	2	1	2	1	1	1	2.16m-3.16m
3	3.2	3	3	1	2	1	1	1	3.16m-
4	m	4	4	1	2	1	1	1	4.16m
5	4.2 6.2	5	5	1	2	1	1	1	5.16m-
6	m m 5.2	6	6	1	2	1	1	1	5.16m 6.16m
7	7.2 m	7	7	1	2	1	1	1	7.16m-8.16m

Remarks : 1. The tracks with length of 500mm, 200mm, 100mm are adjustable tracks, 200mm, 100mm track connectors are connecting pieces for adjustable track, please takenote
 Notice that the shortest track should be mounted on the head of the curtain tracks (closest position to the wall).
 2. Optional accessories: Side mounting bracket, 90 degree angle

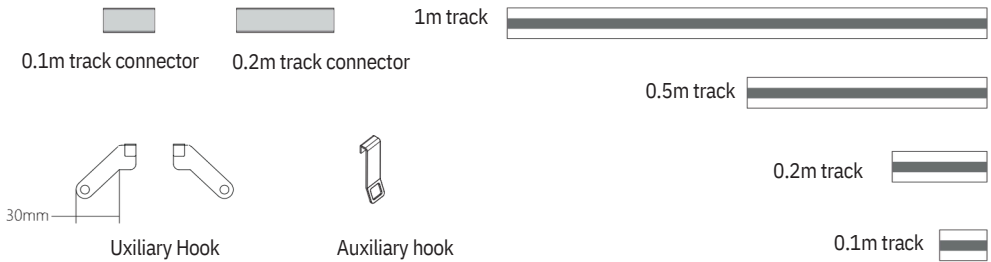

Example: track connect solution

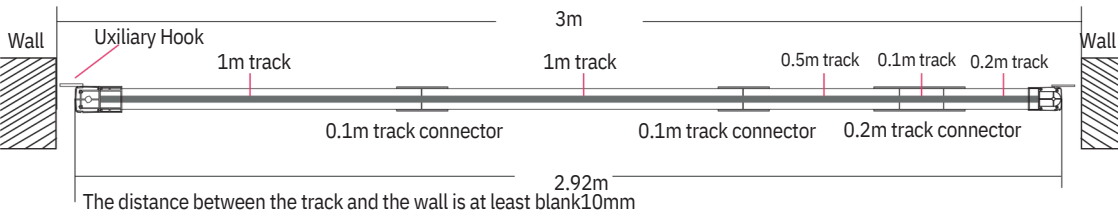

Pay attention to the solution and the position of 0.1m track connector and 0.2m track connector when you use them
 Center opening + Subsidiary opening = 0.12m (length)
 The distance between the track and the wall is at least blank 10mm

Curtain Track Dimension & Measurement

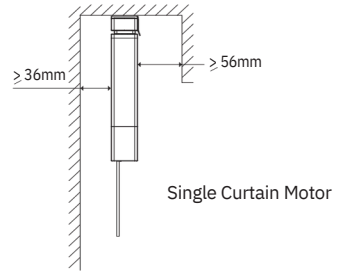
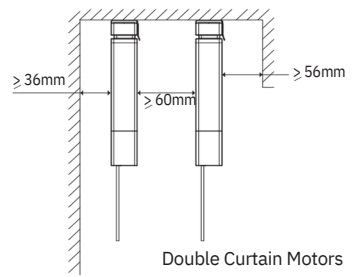
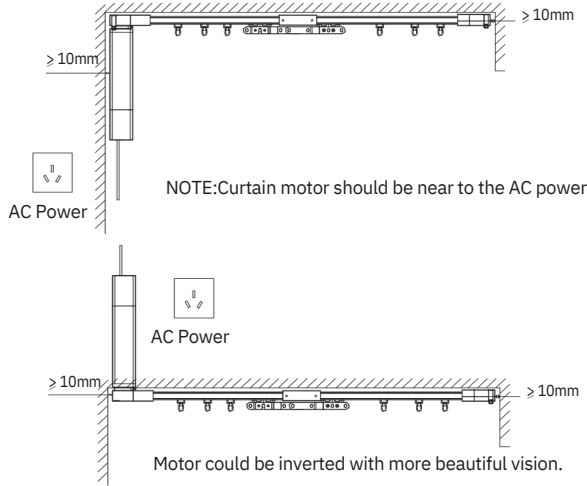

Track Installation Steps

Three sections as an example

- ① Allen wrench
- ② Connections
- ③ Tracks

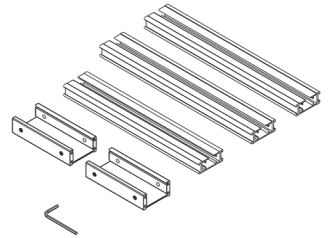

① Place the tracks and connection on flat ground

②

- ① Push the tracks into the connections.
- ② Let the tracks closed in the connection, then tighten the screws through Allen wrench.

NOTE: through tightening the screws, users can adjust the gap of two tracks. No gap, no dislocation.

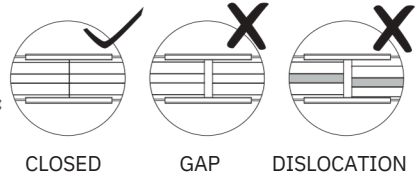
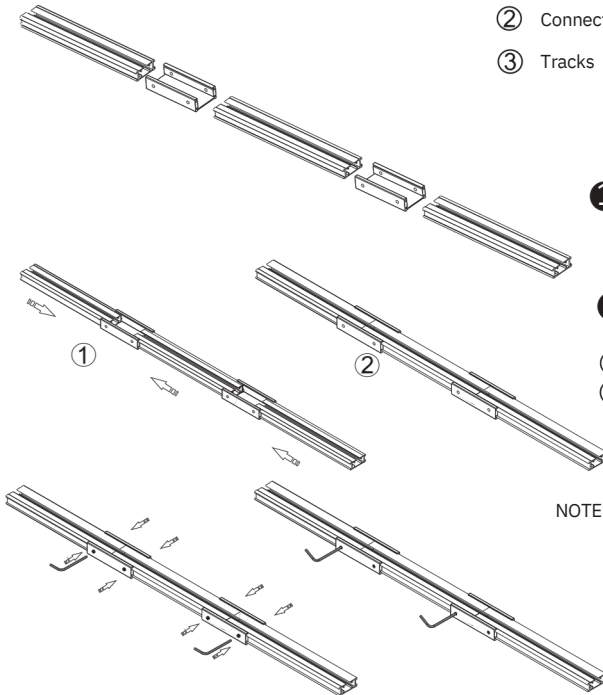

Cutting belt measuring tools instruction manual

Remark: Only applicable double direction opening belt cutting

Double opening direction track needs making two equal length belts in the same way.

The length of belt for single track is the total length of belt for double track plus two teeth. (Just one, don't cut in the middle)

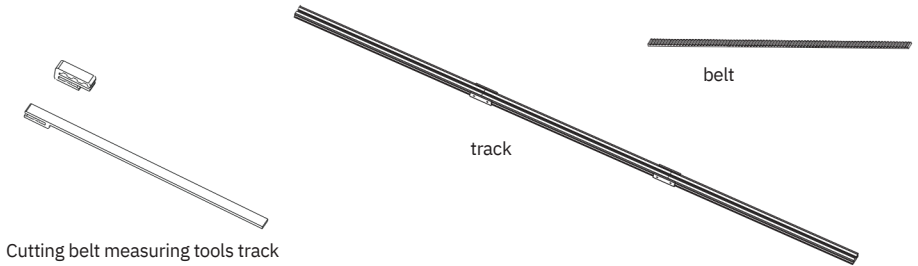

Cutting belt measuring tools track

Take the tail set fixed at 1 end

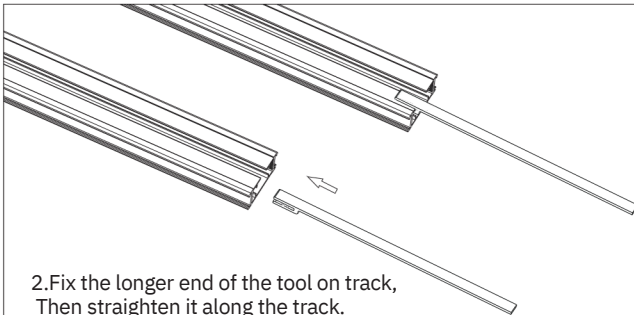
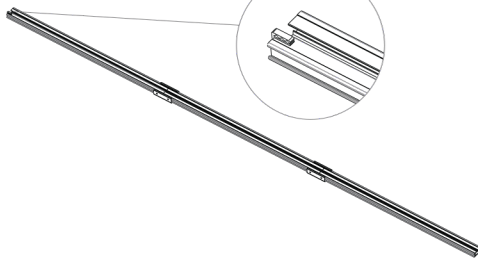
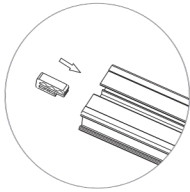

2. Fix the longer end of the tool on track, Then straighten it along the track.

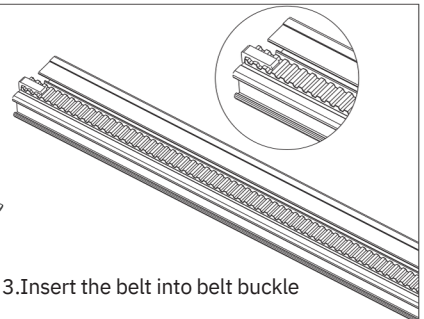

3. Insert the belt into belt buckle

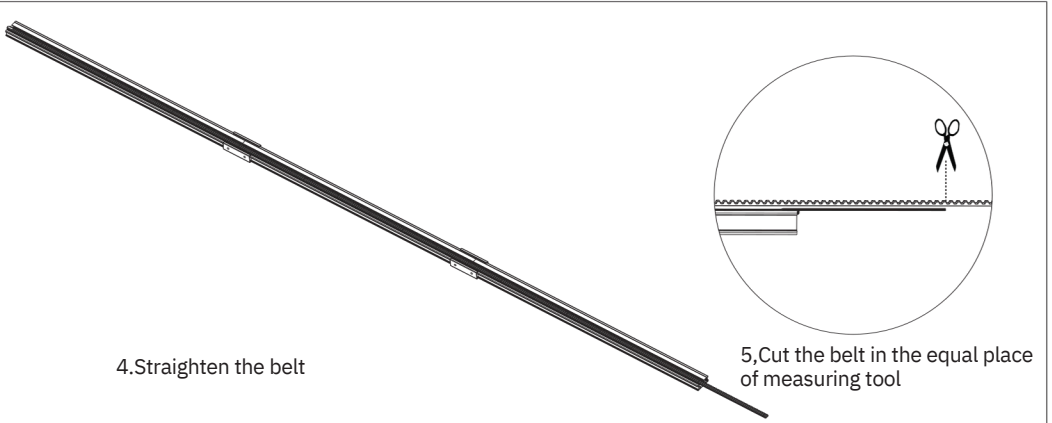

4. Straighten the belt

5. Cut the belt in the equal place of measuring tool

Double-side Open Track Installation Steps

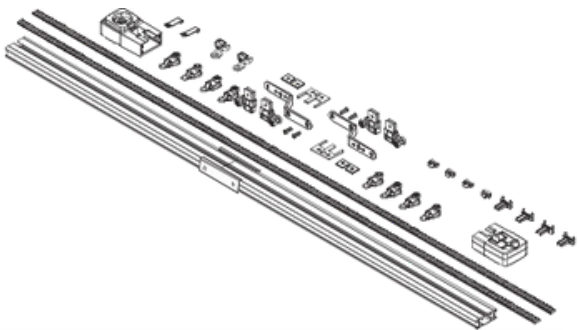

- *Length of Belt=length of track + 11cm:
Customer needs 2 belt in same length.
- *Runners: 8pcs per meter; integer forward
- *2pcs hooks
- *2pcs carriers for Double-side Open
2 sections track as an sample

1

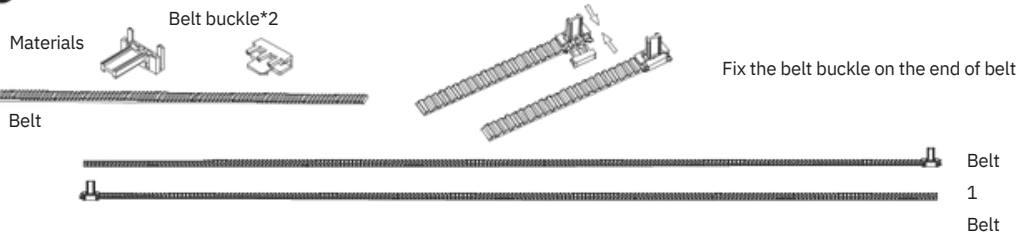

2

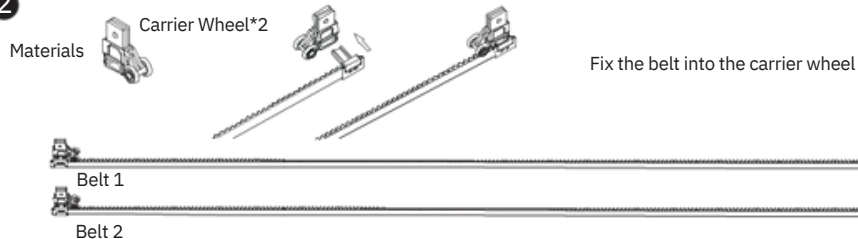

3

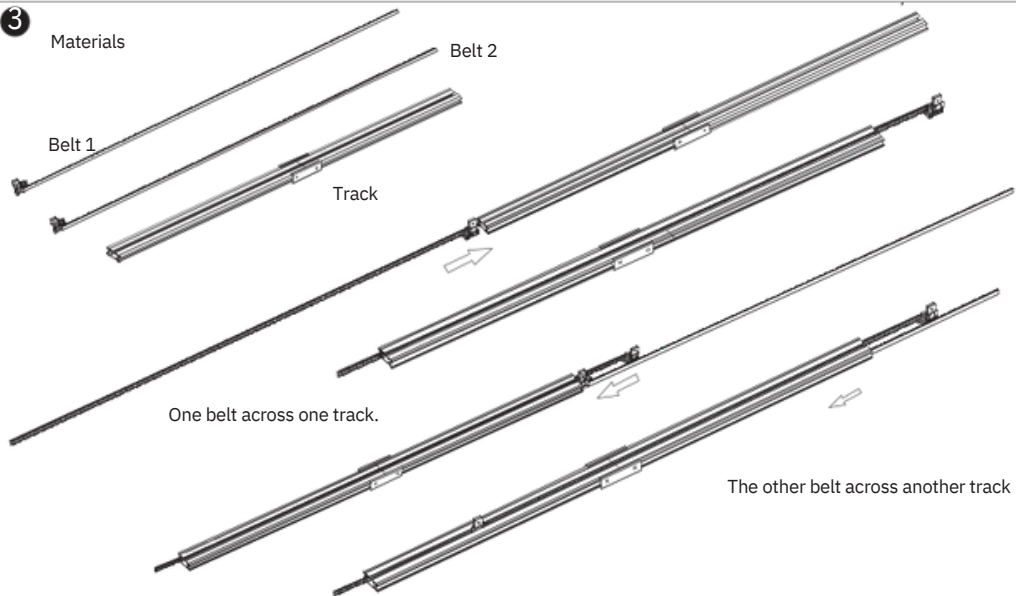

4 Materials



Subsidiary opening
Belt buckle
Carrier wheel
opening

Pull out one belt from the track



Step 1

Step 2

The belt across the subsidiary opening

Fix the belt buckle on the end of belt

Fix the belt on the carrier wheel

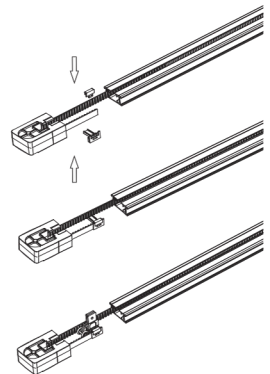

Assemble Subsidiary Opening

1. fix the belt buckle on the belt which has passed the subsidiary opening
2. make the belt buckle and carrier wheel firmly
3. pass the carrier wheel through the track, and push the track in subsidiary opening
4. make the subsidiary opening and track firmly

5

Materials

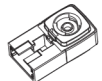
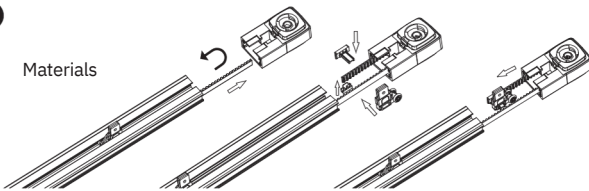

Center opening



Carrier wheel



Belt buckle

Assemble Center Opening

1. the belt across the center opening
2. fix the belt buckle on the end of belt
3. pass the carrier wheel through the track
4. make the center opening and track firmly

6



Carriers*2

Materials

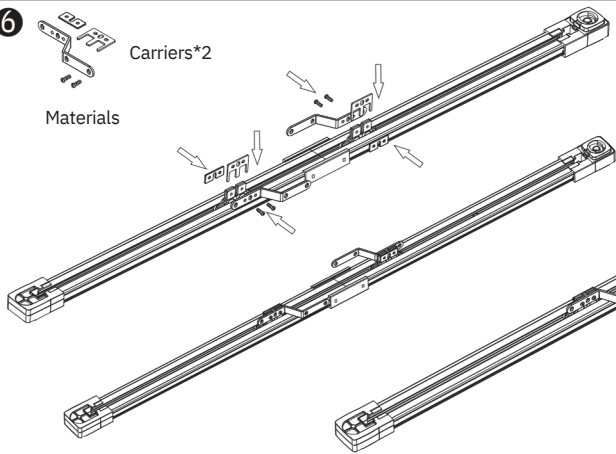

Assemble the Carrier :
according to the figure and tighten the screws.

Rechecking
whether the track can smoothly run, if not,
please recheck the assembling.

7

Materials



Runners

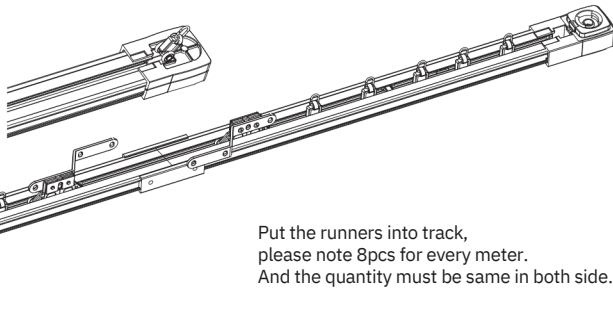

Put the runners into track,
please note 8pcs for every meter.
And the quantity must be same in both side.

8

Materials
Track tensioner

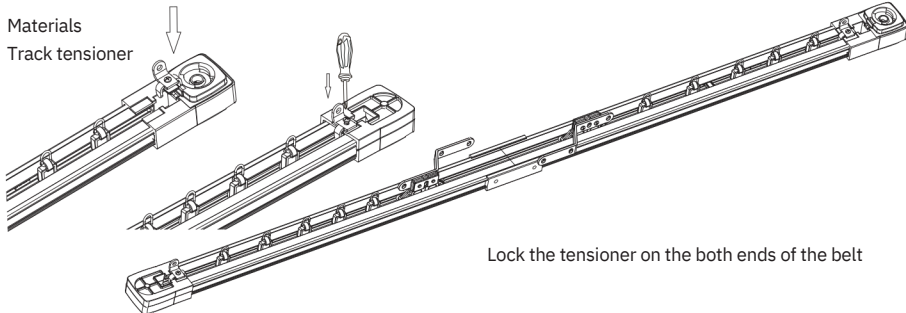

Lock the tensioner on the both ends of the belt

9

Hooks*2

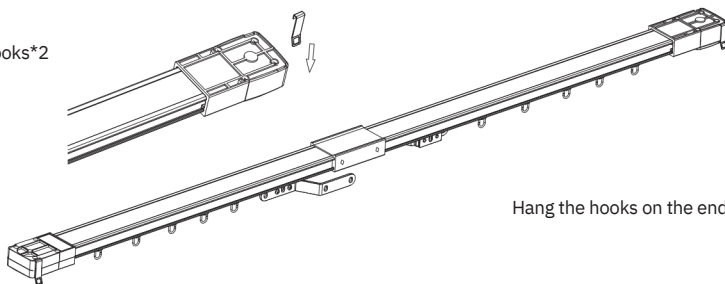

Hang the hooks on the ends of the track

10

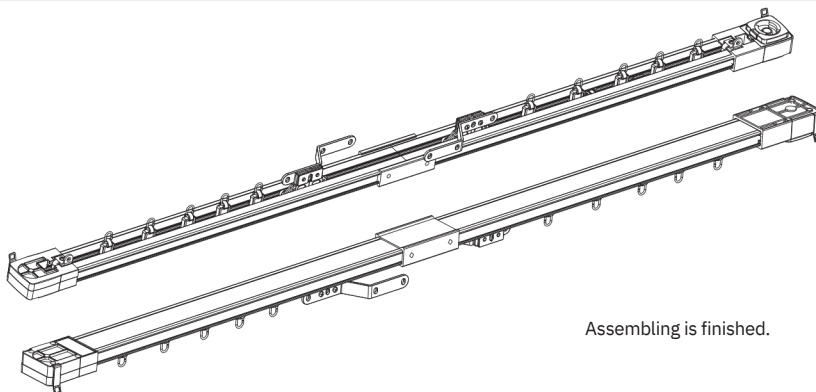

Assembling is finished.

Single-side Open Track Installation Steps

*The length of belt for single track is the total length of belt for double track plus two teeth.(Just one, don't cut it in the middle)



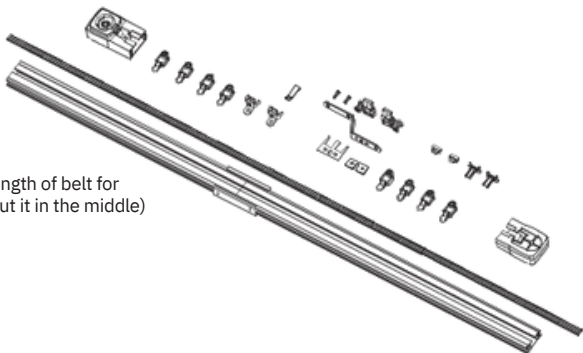

*Runners: 8pcs per meter; integer forward

*1pcs hook

*1pcs carrier for single-side opening
2 sections track as an sample



1





Materials    

Belt buckle Belt

Fix the belt buckle on the end of belt

 Belt



2

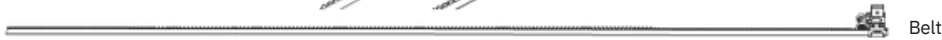

Materials  Carrier Wheel   

Fix the belt into the carrier wheel



 Belt

3

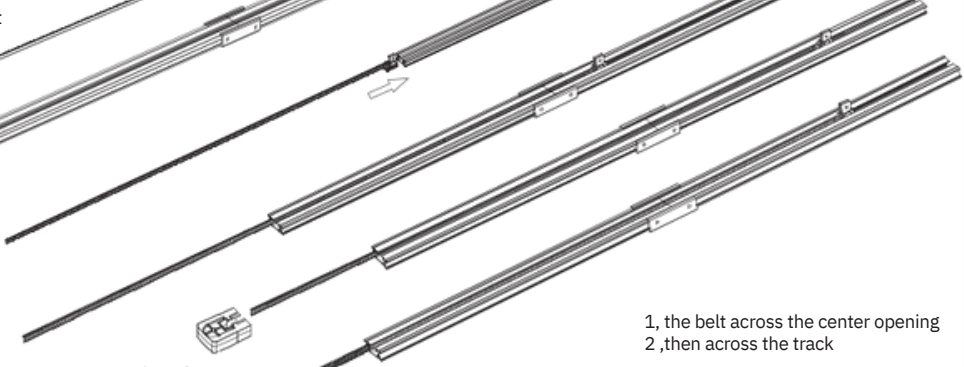
Materials  Subsidiary opening  Track 

Belt    

One belt across one track.

Step 1  Step 2 

1, the belt across the center opening
2, then across the track

4

Materials

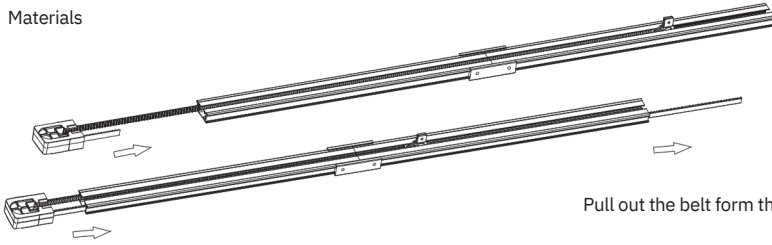

Pull out the belt form the other side of the track

5

Materials

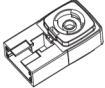

Center opening



Carrier wheel



Belt buckle

Assemble Center Opening

1. the belt across the center opening
2. fix the belt buckle on the end of belt
3. pass the carrier wheel through the track
4. make the center opening and track firmly

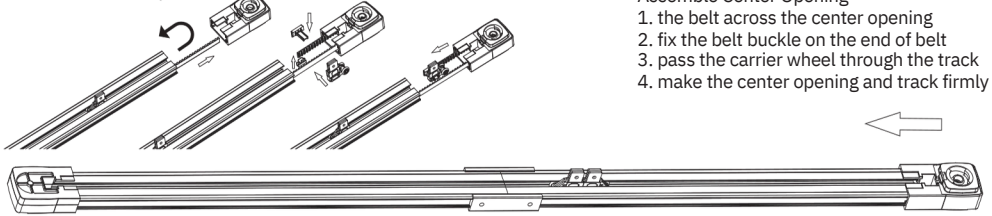

6

Materials

Assemble the Carrier :
according to the figure and tighten the screws.

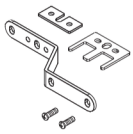

Carriers

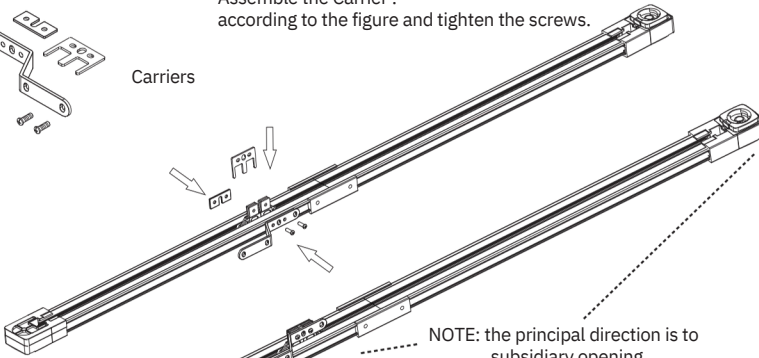

NOTE: the principal direction is to subsidiary opening

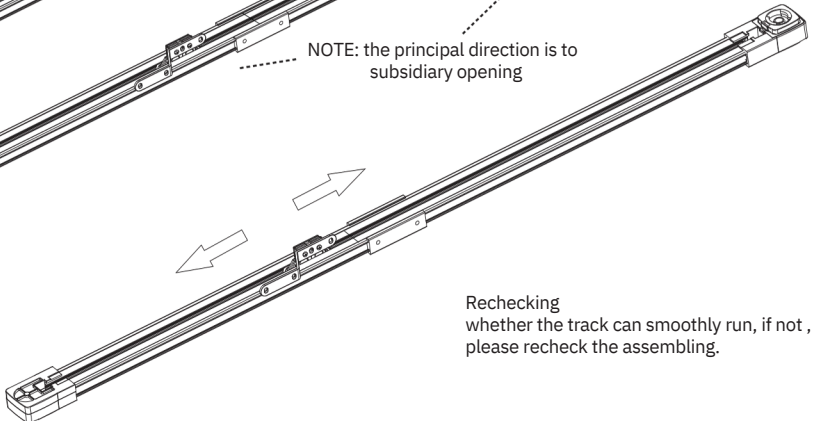

Rechecking
whether the track can smoothly run, if not,
please recheck the assembling.

7

Materials



Runners

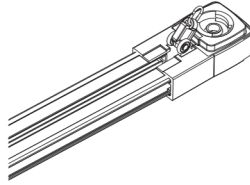

Put the runners into the track, please note 8pcs for every meter.

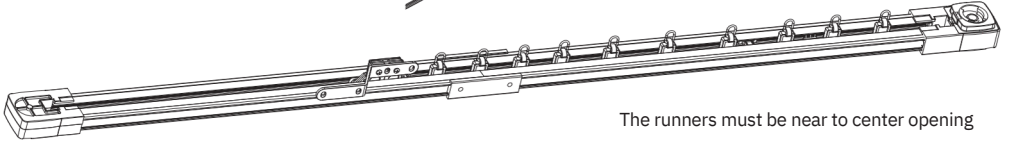

The runners must be near to center opening

8

Materials



Track tensioner

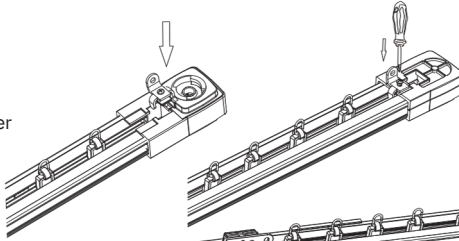

Lock the tensioner on the both ends of the belt

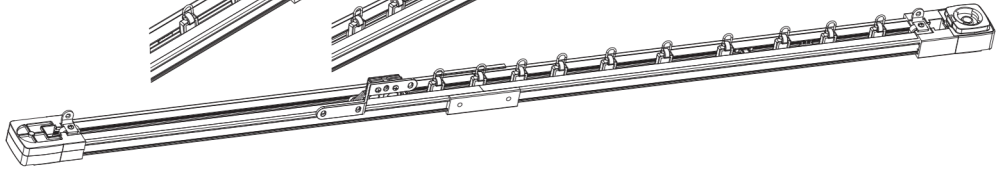

9

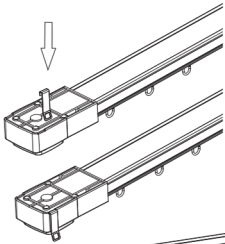

Materials

Hooks

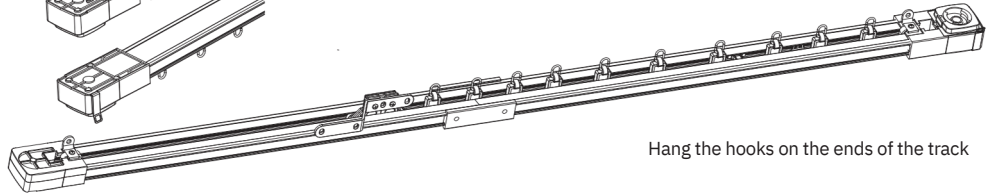

Hang the hooks on the ends of the track

10

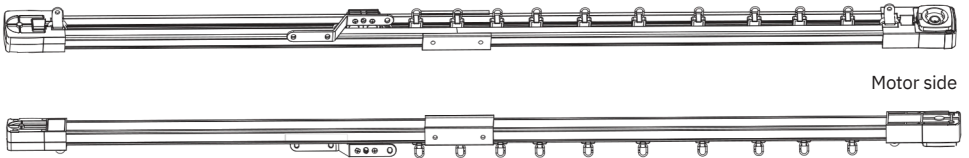

Motor side

Assembling is finished.

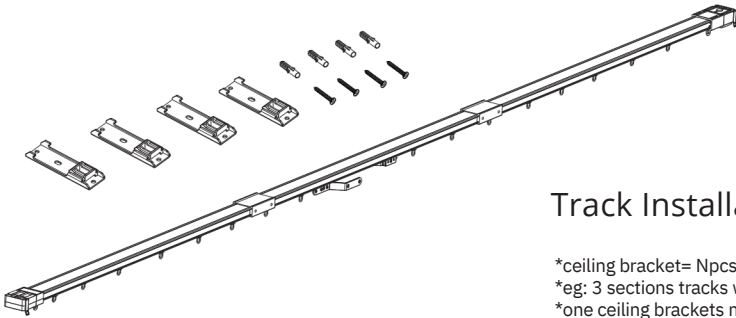

Track Installation Steps

- *ceiling bracket= Npcs section+1pcs
- *eg: 3 sections tracks with 4 ceiling bracket
- *one ceiling brackets must be near to connection.
- *two ceiling brackets should be close to both opening.
- 3 sections track as an sample

1 Location of Ceiling bracket

Materials

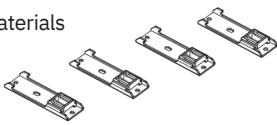

Ceiling bracket*4

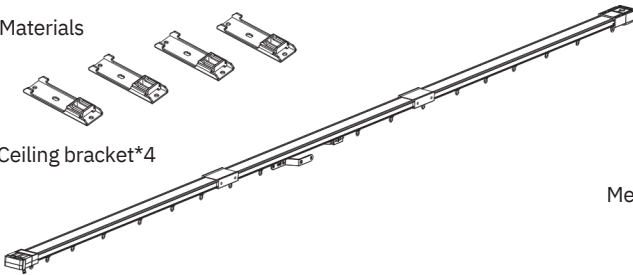

Measuring the distance in advance

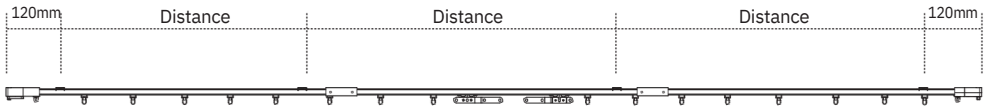

NOTE: One of the ceiling bracket must be near to the connection

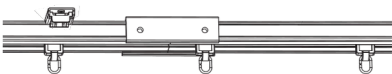

2 Fix the Ceiling bracket

Ceiling bracket*4 & screws

If the wall is concrete or lime wall, please expansion screw

If the wall is a wooden board, fix the screw directly.

(After fixing, the screw must be able to withstand the total weight of the motor, track and curtains.)

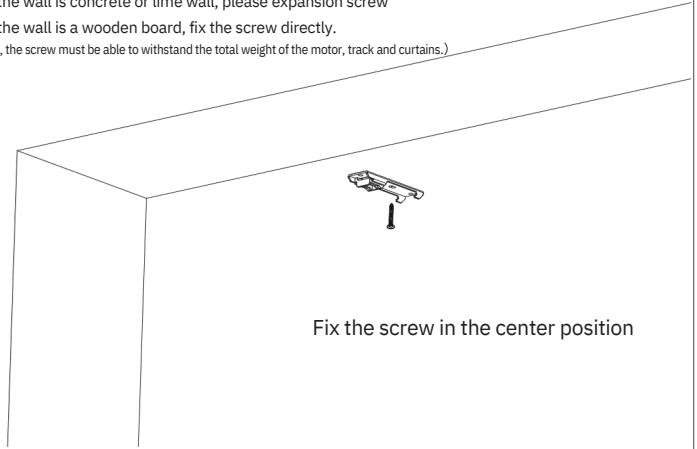
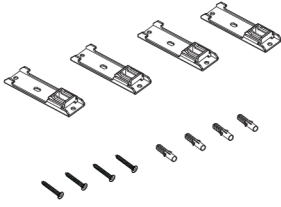

Fix the screw in the center position



After determine the location, mounting the ceiling bracket

(Please make sure the screws are on the same line)

3 Track Installation

Materials

Track*1

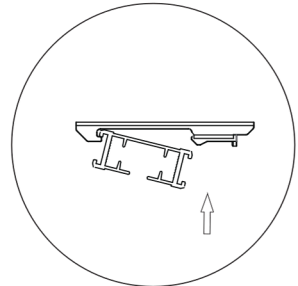
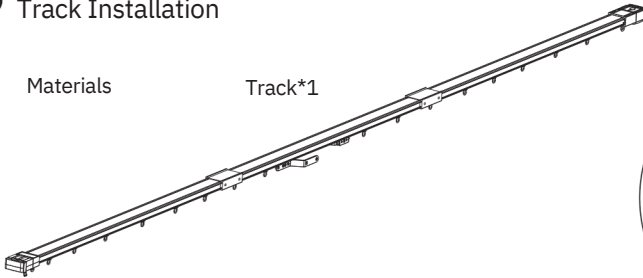

Insert one side of the track, then push and make the track fully go into the ceiling bracket

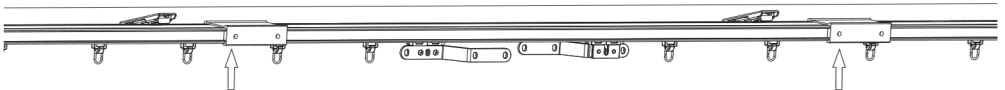

4 TEST

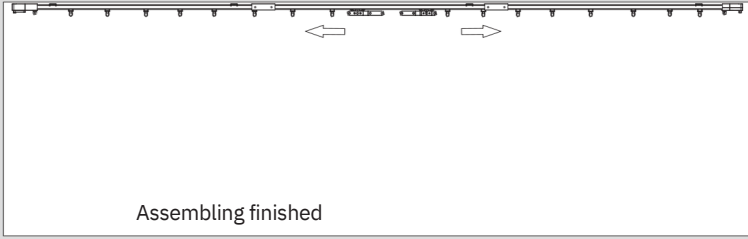

NOTE:

1. recheck the carrier, whether the track can smoothly run, if not ,please recheck the assembling.
2. recheck the connections,keep the connections and track close.
3. the hook should face to the users,not to the wall.

Disassembly of track

Follow the steps



Original state



Slide the lock

Ceiling bracket lock

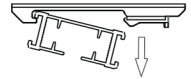

Take off the track

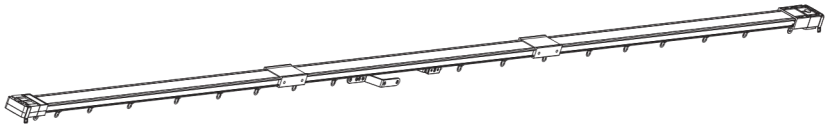

MOTOR

1 Materials

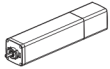

Motor



Track

Shaft & spigot

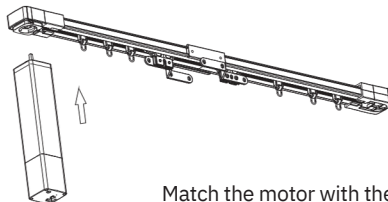
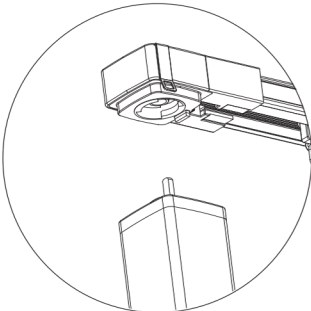

Match the motor with the spigot of the center opening

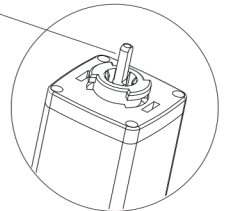
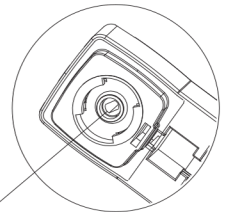

2

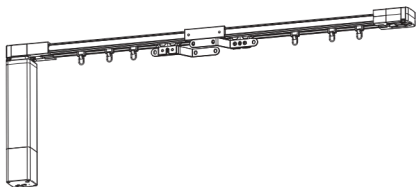

Complete matching

3

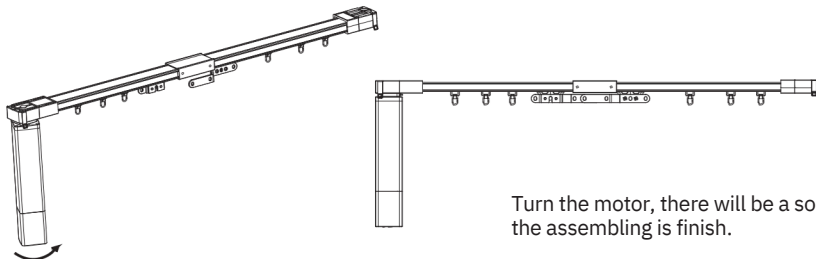

Turn the motor, there will be a sound of lock. the assembling is finish.

Disassembly of motor

1

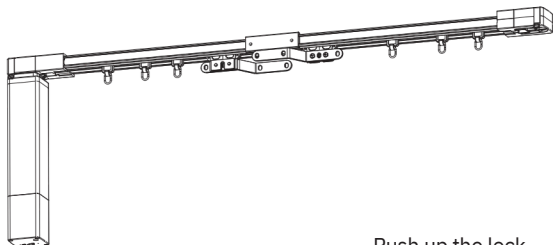

Push up the lock

2

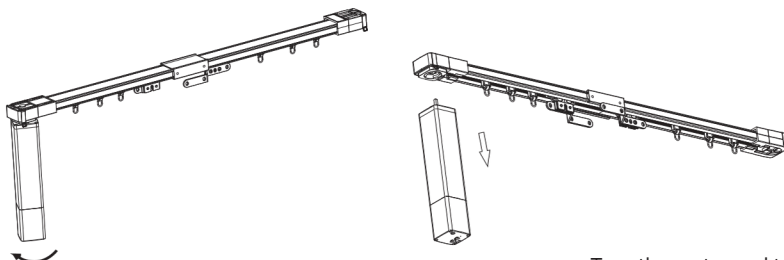

Turn the motor and take it off.

3

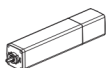

Motor

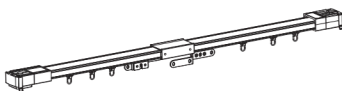

Track

Disassembly is finished.

Emitters

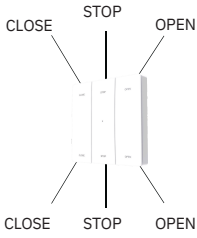

The reverse side

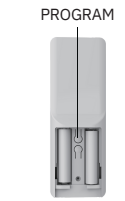

The reverse side



Bracket for wall fixation

Code Matching

Motor is powered on, the light glitters twice and then extinguishes. Within 10s, the motor is in being matched state. After 10s, the being matched state will be closed automatically. The light will extinguish after 3s. Motor have 3 methods for matching. Powered on, Short press PROGRAM and Copy. When the motor is in being matched state, users press the PROGRAM of a totally new emitter, the motor will

Method I : Powered On

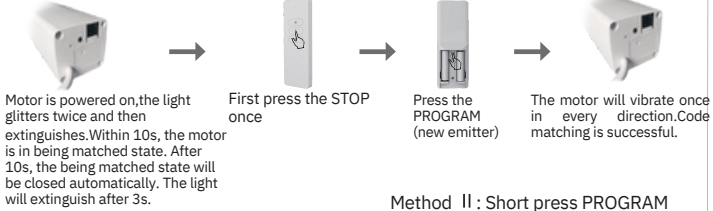

Method II : Short press PROGRAM

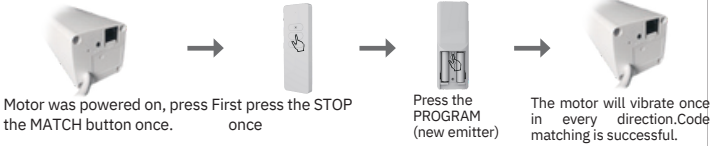

every direction. The vibration code matching of the new emitter is successful.

Method II : copy code

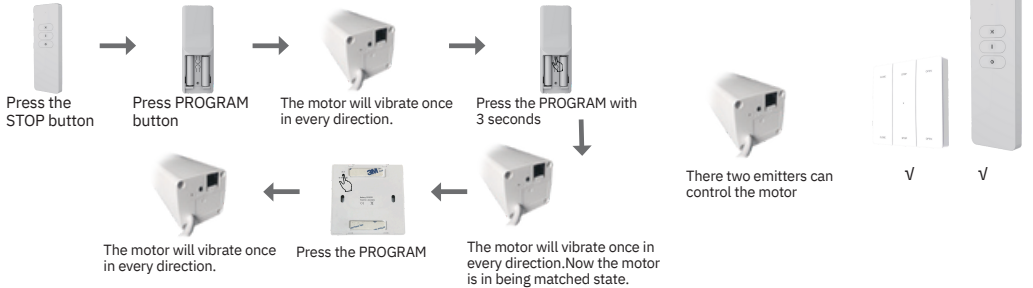

Control the curtain

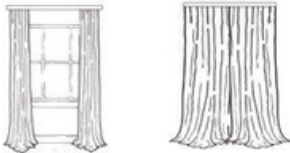

If the curtain run in a different direction from the order of emitter please set the Direction Change function.



Running

Manual operation



Open the curtain by hand

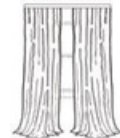

Close the curtain by hand

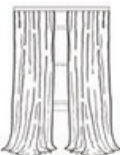

Close the Manual operation Function

Press the STOP & OPEN together till the motor vibrate. The Manual operation function is closed. Users can pull the curtain by hand, but motor can not run. Repeat this operation, this function will restart.

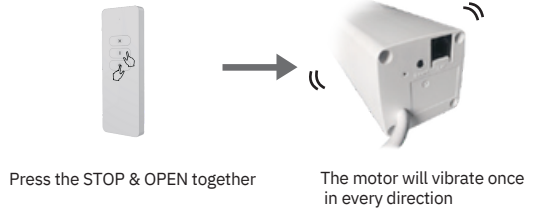

Open the Manual operation Function

Press the STOP & OPEN together till the motor vibrate. The Manual operation function is closed. User can pull the curtain by hand, and the motor can run also. Repeat this operation, this function will restart.

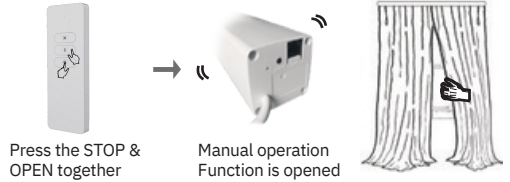

Setting the position

When powered on, the curtain will run without any setting. But motor will calculate the length in order to set the open&close position. And new position will replace the old one.



The operation is same for setting the position of another direction

If the distance of two positions is less than 30cm, the setting is failed.

Delete the position

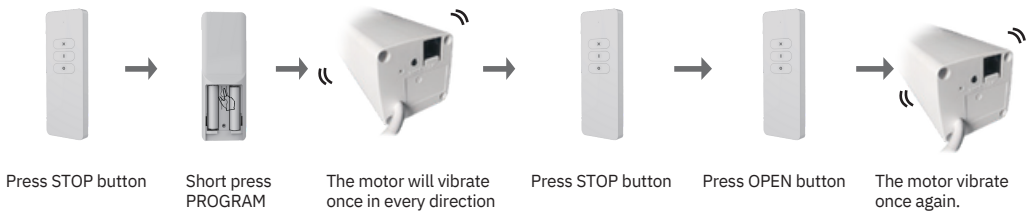

2. Long press the MATCH button, the light will glitter 3 times. Then the motor will vibrate once, all the positions are deleted.



The method is same for deleting the position in another direction

3, Repeat the electricity

Intermediate position

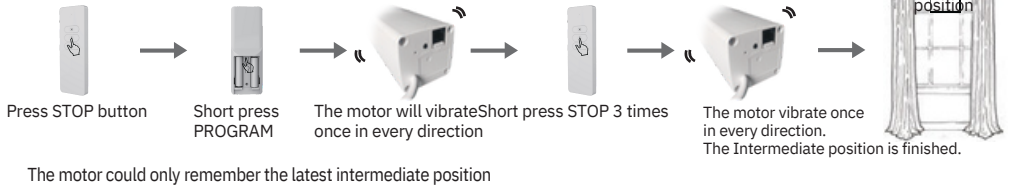

Start the Intermediate position

Long press STOP within 3 seconds, the motor will run to the intermediate position automatically.

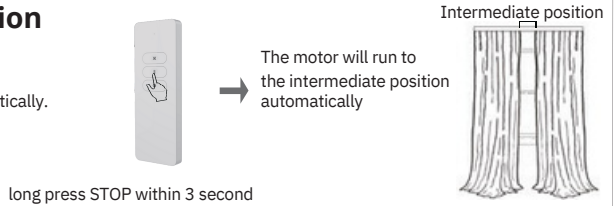

Delete Intermediate position

Method 1: powered on again, all positions are deleted.
Method 2: long press MATCH button

Direction Change

When the motor run in different direction which is not same as the emitter order, user could operate as follows:

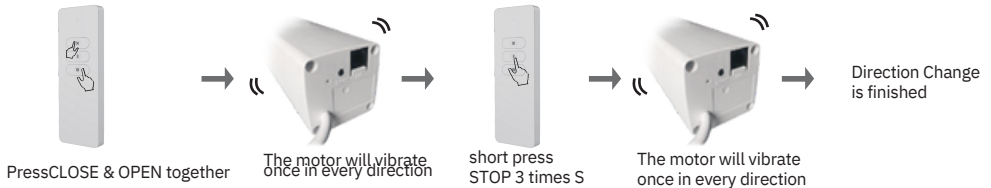

Delete the current emitter



Delete all emitters

Press OPEN and CLOSE together, the motor will vibrate. Then press OPEN 3 times, the motor vibrate again. Delete all emitters.

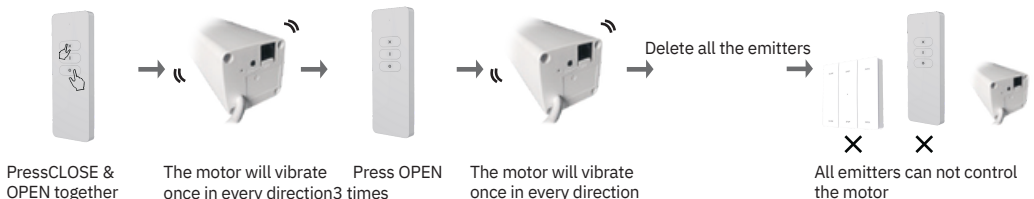

Factory reset After factory reset, the motor will lose all positions. At this time, the first manual function will as the first choice .

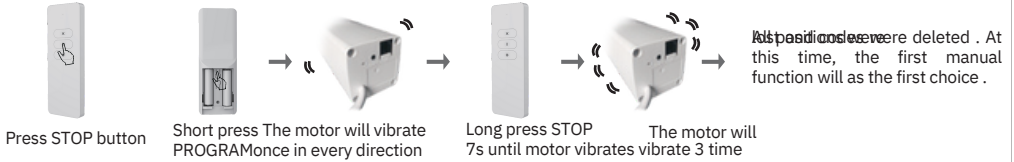

NOTE:

1. When the motor stop running or finish the setting, the light will keep bright in 3 seconds.
2. after 4mins running , the motor will stop to protect.
3. if the motor is too hot, it will stop to protect. With the temperature dropping, the motor will restart.

RJ116P6C Connection

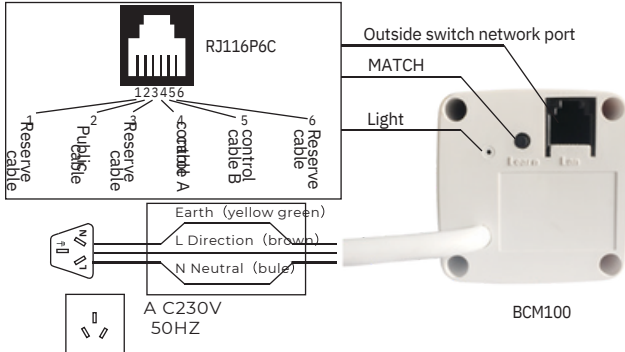

Manual switch (RJ11)
note: manual switch is the default setting.

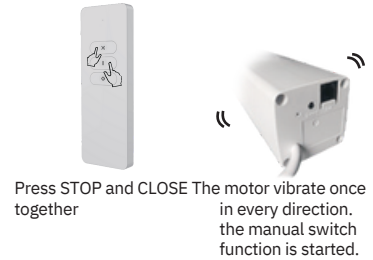

Through this operation, motor will change the following manual switches in turn.

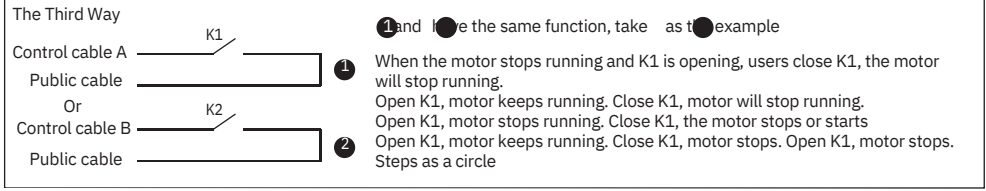
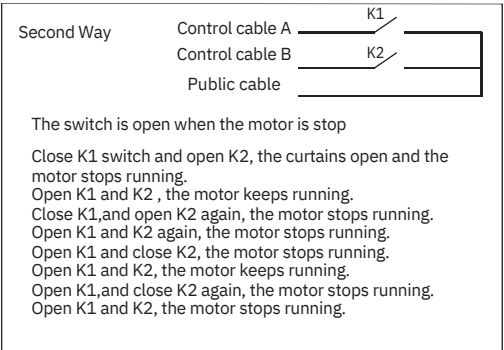
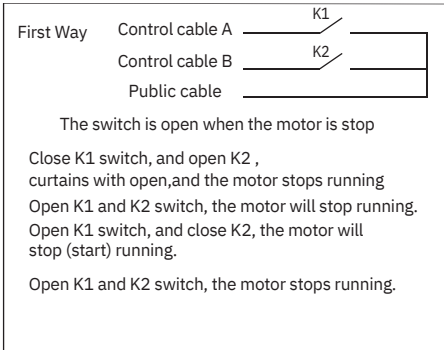

PROBLEM & SOLUTION

- * **Not smoothly running:** adjust the screws of the connections.
- * **Motor stops running:** check the electricity and voltage
- * **Emitter :** check the battery and code matching.
- * **temperature protection:** the AC motor will stop with long-time running. But manual operation function is still available , also motor will remember the position.